

## TORNILLO DIN 965 / ISO 7046 INOXIDABLE A-2

SCREW DIN 965 STAINLESS STEEL AISI 304  
 VIS FILETAGE MÉTRIQUE DIN 965 EN ACIER INOX. A-2  
 SENKKOPFSCHRAUBE DIN 965 - EDELSTAHL A-2

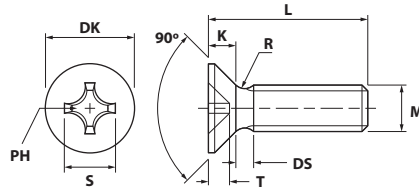

CAJA / BOX / BOÎTE

CÓDIGO / Code / Code: **965A2**

**INOX. A-2 / S.S. AISI 304**

UNIDADES X CAJA / Units x box / Unités x boîte

| MxL (m.m.)                          | M3   | M4   | M5   | M6    | M8    |
|-------------------------------------|------|------|------|-------|-------|
| 6                                   | 200  | 200  |      |       |       |
| 8                                   | 200  | 200  | 200  |       |       |
| 10                                  | 200  | 200  | 200  | 200   |       |
| 12                                  | 200  | 200  | 200  | 200   | 100   |
| 16                                  | 200  | 200  | 200  | 200   | 100   |
| 20                                  | 200  | 200  | 200  | 200   | 100   |
| 25                                  | 200  | 200  | 200  | 200   | 100   |
| 30                                  | 200  | 200  | 200  | 200   | 100   |
| 35                                  |      | 200  | 200  | 200   | 100   |
| 40                                  |      | 200  | 200  | 200   | 100   |
| 45                                  |      | 200  | 200  | 200   | 100   |
| 50                                  |      | 200  | 200  | 100   | 100   |
| 60                                  |      |      | 200  | 100   | 100   |
| <b>MEDIDAS / Measures / Mesures</b> |      |      |      |       |       |
| Paso / Pitch                        | 0,50 | 0,70 | 0,80 | 1,00  | 1,25  |
| DS max.                             | 1,00 | 1,40 | 1,60 | 2,00  | 2,50  |
| B                                   | 19   | 22   | 25   | 28    | 34    |
| DK max.                             | 5,60 | 7,50 | 9,20 | 11,00 | 14,50 |
| DK min.                             | 5,30 | 7,14 | 8,84 | 10,57 | 14,07 |
| K max.                              | 1,65 | 2,20 | 2,50 | 3,00  | 4,00  |
| R max.                              | 0,80 | 1,00 | 1,30 | 1,60  | 2,00  |
| S ≈                                 | 2,90 | 4,40 | 4,60 | 6,60  | 8,70  |
| T max.                              | 1,80 | 2,40 | 2,60 | 3,30  | 4,32  |
| PH (Phillips)                       | 1    | 2    | 2    | 3     | 4     |

AUTOSERVICIO / SELF-SERVICE / AUTO-SERVICE

**INOX. A-2 / S.S. AISI 304**

CÓDIGO  
Code / Code

MEDIDA  
Measure / Mesure

MxL  
m.m.

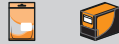

|              |             |     |    |
|--------------|-------------|-----|----|
| BF965A204010 | <b>4x10</b> | 100 | 12 |
| BF965A204016 | <b>4X16</b> | 100 | 12 |
| BF965A204020 | <b>4x20</b> | 75  | 12 |
| BF965A205010 | <b>5x10</b> | 100 | 12 |
| BF965A205016 | <b>5X16</b> | 75  | 12 |
| BF965A205020 | <b>5x20</b> | 75  | 12 |

AUTOSERVICIO / SELF-SERVICE / AUTO-SERVICE

**INOX. A-2 / S.S. AISI 304**

CÓDIGO  
Code / Code

MEDIDA  
Measure / Mesure

MxL  
m.m.



|              |             |    |    |
|--------------|-------------|----|----|
| BF965A205025 | <b>5x25</b> | 75 | 12 |
| BF965A206010 | <b>6x10</b> | 75 | 12 |
| BF965A206016 | <b>6x16</b> | 75 | 12 |
| BF965A206020 | <b>6x20</b> | 50 | 12 |
| BF965A206025 | <b>6x25</b> | 50 | 12 |
| BF965A206030 | <b>6x30</b> | 50 | 12 |

PEDIDO MÍNIMO 1 EMBALAJE / MINIMUM ORDER 1 PACKAGING / COMMANDE MINIMALE 1 EMBALLAGE / MINDESTBESTELLMENGE 1 VERPACKUNG